



Portable Electric Breast Pump

輕巧手持電動吸乳器

流線質感新接觸!

1. 輕巧隨身帶著走

2. 貼附式花瓣吸乳罩

3. 舒緩漲奶疼痛裝置

4. 簡易式操作介面

5. 高效能吸力主機



0%

BPA

不含雙酚A



■ 各 部 件 說 明 / Materials

- | | |
|----------------------------------|------------------------|
| 1.主機體與電池匣/Main Powered | ABS (-10℃~80℃) |
| 2.花瓣墊片/Breast Shield Insert | 矽膠Silicone (-10℃~120℃) |
| 3.吸乳罩杯/Breast Shield | PP (-10℃~110℃) |
| 4.防漏連接墊片/ Rubber | 矽膠Silicone (-10℃~120℃) |
| 5.奶瓶/Bottle | PP (-10℃~110℃) |
| 6.幫浦清潔接頭/Pump Clean Connector | PP (-10℃~110℃) |
| 7.奶嘴/Nipple | 矽膠Silicone (-10℃~120℃) |
| 8.奶瓶中蓋/Bottle Ring | PP (-10℃~110℃) |
| 9.奶瓶上蓋/Bottle Cap | PP (-10℃~110℃) |
| 10.底座/Stand | ABS (-10℃~80℃) |
| 11.開關/ON-OFF Switch | ABS (-10℃~80℃) |
| 12.吸力調整鈕/Suction Regulator | ABS (-10℃~80℃) |
| 13.洩氣閥門/Release Valve | POM (-10℃~110℃) |
| 14.DC 3V接孔/DC 3V Connecting Hole | |

■ 安裝方式 /Installation:

- 將(2)花瓣墊片放入(3)吸乳罩杯中使之緊密結合。
 - 將(4)防漏連接墊片放入(3)的螺紋部分。
 - 將(1)主體垂直插入(3)吸乳罩中使之緊密結合。
 - 將組合好的機體及吸乳罩與(5)奶瓶，以順時針方向上緊。
- *使用前請先注意所有零件是否正確的組合。

- Put (2) Breast Shield Insert into (3) Breast Shield and connect them tightly.
- Put (4) Rubber into the screw thread of (3) Breast Shield.
- Insert vertically (1) Main Body into (3) Breast Shield and connect them tightly.

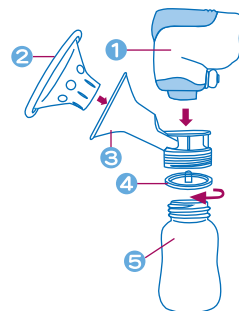

- Tighten upward the combined Main Body, Breast Shield and (5) Milk Bottle by clockwise direction.
- * Before use, please pay attention to the correct combination of all parts.

■ 電池安裝 / Battery Installation:

- 將電池夾蓋推開。
- 使用2枚3號AA型電池(本產品限使用鹼性電池)。
- 安裝電池~使電池之(+)極及(-)極與電池匣上標示吻合。
- 裝回電池匣蓋。
- 若長期不使用請將電池取出。
- 使用AC轉接器時，請將插頭插入(DC3V)主機上方前端插孔(注意：請使用吸乳器專用的AC轉接器，若使用其他轉接器，可能會引起故障或不可預知的危險，請勿使用。)

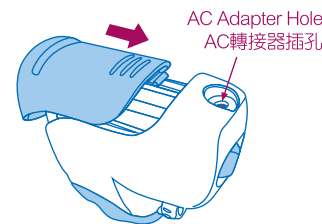

- Open the battery cartridge cover.
- Use 2 pcs of 3 AA batteries (This product is limited to use alkaline batteries only.)
- Install the batteries ~ make (+) positive and (-) negative of the battery consistent with the marks in the battery cartridge.
- Put back the battery cartridge cover.
- If this product will not be used for a long time, please remove the batteries.
- When the AC Adapter is used, please insert the plug (DC3V) into the front jack on the top of main body. (Note: please use the AC Adapter dedicated for Breast Pump. If use the other adapter, it might cause breakdown or unpredictable danger. Please don't use it.)

■ 保 證 書 (憑保證書，可免費修理本書所記載的內容)

自購買日起一年內，若主機發生故障，請攜帶本保證書逕向本公司顧客服務中心或原經銷商洽詢。

保證內容：

在保證期間內(購買日起一年內)，在正常使用狀況下，發生故障時可免費服務維修。

◆在保證期間內，如因下列情況而發生故障者，本公司酌收檢修費。

- (1) 使用不當或任意改裝，擅自修理所造成的故障或損壞。
- (2) 購買後因掉落所導致的故障或損壞。
- (3) 因火災、地震、水災、打雷以及其他天災公害、異常電壓所造成的故障或損壞。
- (4) 一般家庭用之外，使用於其他營業方面所造成的故障。
- (5) 本書中未記載購買日期，顧客名，店家名或字句塗改者。
- (6) 未出示保證書時。

◆用戶請妥善保存本保證書，如遺失、毀損恕不補發。

保 證 書

品 名	輕巧手持電動吸乳器	
貨 號	KU9017	
保證期限	保證對象	期間(自購買日起)
	主機	1年
購買日期	年 月 日	
顧客資料	姓名：	電話：
	地址：	

經銷商/店家	修理紀錄
名稱：	
地址：	
電話：	

※憑保證書，於保證期間內，本書所記載之內容可免費修理。超過保證期限，本書不具任何法律效力。若對保證期限後的修理有任何不瞭解的地方，請逕向本公司客服中心或經銷商洽詢。

 **吉尼寶貝國際股份有限公司**
JINI BABY INTERNATIONAL CO.,LTD.
No.27, Lane 290, Sec.2, Jia Dong Road, Chang Hua City 500-84, Taiwan
台灣彰化市茄萇路2段290巷27號 TEL:0800-223358 統一編號:12617114
原產地:台灣 Made in Taiwan www.ku-ku.com.tw

操作說明 / Instruction for use :

建議本產品電源以AC轉接器效果最佳！

- 1.將花瓣墊片放入吸乳罩杯中，使之緊密結合。（花瓣墊片的隆起設計在促進乳汁分泌。）
- 2.將吸乳罩與奶瓶旋緊。
- 3.輕輕的將吸乳罩緊貼胸部使乳頭位於花瓣墊片的中間。
- 4.吸乳方式：滑動電源開關至ON（具持續吸乳功能）以啟動吸乳器。
- 5.調節鈕用於吸乳時調節吸力，增強時往順時鐘方向旋轉，減弱時往逆時鐘方向旋轉。
- 6.在獲得適當吸力後輕按釋放鈕（PUSH）2至3秒鐘，再鬆開該鈕來引動吸力，如此可模擬嬰兒的吸乳動作，更可按摩您的胸部，使吸乳更順暢，重複此動作直到所需的母乳量獲得為止。（另一隻手同時按摩乳房吸乳效果更好）
- 7.當結束母乳收集後，按壓吸力釋放鈕（PUSH）釋放吸力，並將開關關閉。
- 8.垂直輕拉方式小心的取出主機體（取出時請勿左右轉動）。
- 9.以反時針方向轉動卸下吸乳罩。取出乳頭連接墊片。將奶嘴放入奶瓶蓋並以順時針方向轉接在奶瓶上，即可使用此奶瓶餵奶。

* Suggest use AC Adapter as the power supply of this product for optimal effect.

1. Put Breast Shield Insert into Breast Shield and connect them tightly. (The uplift design of Breast Shield Insert is to promote milk secretion.)
2. Tighten Breast Shield and Milk Bottle firmly.
3. Let Breast Shield be close to the breast slightly and make Teat located in the middle of Breast Shield Insert.
4. Sucking Method : Slip the power switch to ON (with continuous sucking function) to start Breast Pump.
5. The Suction Regulator is to adjust the sucking force while sucking. To enhance, please turn it clockwise; to weaken, just turn anti-clockwise.
6. After getting the proper sucking force, press the Push button slightly for 2~3 seconds and then release the button to motivate the suction, so that it will simulate baby's sucking action and even massage your breast for smoother sucking. Repeat this action until the required milk volume. (Use another hand to massage breast at the same time for better sucking effect.)
7. After finish collecting the breast milk, press the Push button to release the sucking force and turn off the switch.



8. Push out the main body vertically and carefully (when take it out, do not turn it left and right.)
9. Turn anti-clockwise to remove the Breast Shield. Take out Breast Shield Insert. Put Teat into Bottle Cover and connect to the Milk Bottle by clockwise direction, so that the Milk Bottle can be used to feed baby.

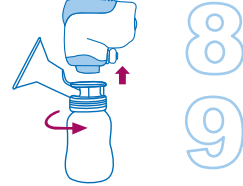

■ 清潔方式 / Cleaning way :

第一次使用前及每次使用後以柔性清潔劑或溫水清洗所有零件(主機體與電池匣除外)。可將奶嘴、奶瓶、吸乳罩的配件置於消毒鍋內消毒（主機體除外）。

清潔主機體的方法

建議每次使用後遵照下列步驟保養，以防止或除去主機體及馬達組件上任何可能留下的奶水。

- 1.卸下奶瓶上的主機體。
- 2.將幫浦清潔接頭裝在主機體下方。
- 3.將清潔接頭浸入小型溫水容器內約2cm處。
- 4.將幫浦清潔接頭放入容器內使幫浦排氣孔位於容器外面，（此種作法極為重要，可防止污水排回至容器乾淨的水內）若使用AC轉接器則確定AC轉接線不得與水接觸。
- 5.清潔主機時，打開電源開關，在幫浦排水孔流出清潔的水後，抽出主機體並讓馬達空轉約30秒以除去主機體內過多的水。
- 6.用紙巾將主機體擦拭乾淨以防蟻蟻入侵，保存好準備下次使用。



Before the initial use and after each use, wash all of the parts by mild detergent or warm water (except for the main body and battery cartridge). The Nipple, Milk Bottle, and Breast Shield Insert can be sterilized in a Sterilizer (except for the Main Body).

The way to clean the Main Body : After each use, suggest do the maintenance according to the following to procedures to prevent any possible residue milk in the main body and motor parts.

- 1.Disassemble the Main Body from the milk bottle.
- 2.Install the Pump Cleaning Connector below the Main Body.
- 3.Dip the Cleaning Connector into small warm water container about 2 cm.
- 4.Put Pump Cleaning Connector into the container to let Pump Vent be outside the container. (This way is very important to prevent the dirty water draining into the clean water in the container.) If use AC Adapter, make sure AC Adapter can not contact with water.
- 5.When clean the Main Body, open the power switch. After the cleaning water flowing from Pump Vent, draw out the Main Body to make motor turn idly for about 30 seconds to remove the water inside the Main Body.
- 6.Use paper tissue to wipe the Main Body cleanly to avoid the entry of ants and preserve it well for use next time.

注意事項 / Notes:

- 1.當使用3號AA 鹼性電池，LED燈熄滅或吸力不足時表示電力不足，請更換一組新電池即可恢復正常功能。
- 2.使用時務必將主體固定在垂直位置，若主機體傾斜會使母乳進入馬達與電池匣內造成損壞，若不小心滲入請立刻關閉電源，取出幫浦與電池匣，將幫浦開啟讓馬達運轉2~3分鐘，然後關閉馬達，將馬達與電池匣內的母乳甩出，再用乾淨布將電池匣擦乾淨。
- 3.切勿將主機體及馬達與電池匣浸在水中或用水沖洗。

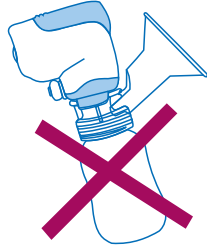

- 1.When use 3 AA alkaline batteries, if LED light vanishes or sucking force is not enough, it means the shortage of electricity. Please replace a new set of batteries to return to normal function.
- 2.When use it, make sure the main body is fixed in the vertical position. If the main body tilts, the breast milk will enter into motor and battery cartridge to cause damage; in case it does, please turn off the power immediately and take out the pump and battery cartridge, and start the pump to let motor rotate for 2~3 minutes and then turn off the motor. Throw the milk inside the motor and battery cartridge out and then clean the battery cartridge by clean cloth.
3. Do not dip the main body, motor and battery cartridge into the water nor wash with water.

■ 故障排除 / Trouble-shooting :

* 無法啟動時：

- 1.檢查放置的電池極性是否正確。
- 2.檢查電池接點是否緊密連接。
- 3.使用AC轉換器，則確定轉接器接頭與接線插頭是否正確插入。

* 無法吸乳時：

- 1.確定所有組件是否正確旋緊組合完成。
- 2.檢查電池電力是否正常。
- 3.至少讓馬達運轉30秒以獲得最大吸力（注意：當電池電力衰減時，吸力會減弱）。
- 4.檢查調節鈕是否調為無吸力狀態。

* 吸力不足：

- 1.當LED燈不亮時，即表示電力不足，請更換一組新的鹼性電池。或使用AC轉接器會改善幫浦的吸力。
- 2.檢查吸乳罩和胸部是否密合。

* Unable to start it :

- 1.Check the position of battery polarity is correct.
- 2.Check the connected point of battery is connected tightly.
- 3.Use AC Adapter and make sure the connector of adapter and wiring plug are inserted correctly.

* Unable to pump milk :

- 1.Make sure all of the parts are correctly fastened and connected completely.
- 2.Check the power of battery is normal.

- 3.Turn the motor for 30 seconds at least to obtain the maximum sucking force. (Note: When the battery power is attenuating, the sucking force will weaken.)
- 4.Check the adjusting knob is turned to the state of no suction.

* The sucking force is not enough:

- 1.When LED light will not flash, it means the power is not enough. Then please replace a new set of alkaline batteries. Or use AC Adapter to improve the sucking force of pump.
- 2.Check Breast Shield and breast are close enough.

■ 吸乳要點及注意事項/Pumping Instruction and Attention

- 1.如於剛生產後，初乳較少階段欲使用吸乳器，請依照醫生指導使用。
- 2.乳腺炎或乳頭塌陷、扁平者，請接受醫師或助產士指導使用。
- 3.以手擠壓乳房無法擠出母乳者，請勿使用本產品，並接受醫師或助產士指導使用。
- 4.吸乳前按摩乳房或覆蓋溫濕布熱敷，可促進母乳分泌，較易於擠乳。
- 5.請勿過度使用或沒有間斷的吸取母乳。

1. After giving birth, if the breasts supply low milk and you need to use the breastpump, please consult your lactation consultant or doctor for directions.
2. For the case of mastitis, inverted or flat nipples, please consult your doctor or lactation consultant for dilrections.
- 3.Do not use this product if milk cannot be expressed with hand. Please consult your doctor or lactation consultant for directions.
4. Breast massage or cover the breasts with a warm cloth to encourage the milk supply before pumping.
5. Do not use pumping excessively or non stop of suction movement.

■ ☆ 商品推薦 ☆

酷咕鴨儲乳瓶-3入組 150ml

當媽媽集乳到達奶瓶刻度上限時，建議更換新的儲乳瓶來集乳，方便管理母乳容量，酷咕鴨儲乳瓶3入裝，讓媽媽能夠儲存更多珍貴的母乳。

- 奶瓶可以接上標準口徑的奶嘴，使用方便。
- 可直接裝在吸乳器上當集乳瓶，冷凍與冷藏皆方便。
- 可套上奶嘴及中蓋直接當奶瓶使用。
- 食品級PP材質，可高溫消毒殺菌。
- 可重複使用，經濟方便又衛生。

KU.KU Duckbill Storage Milk Bottle Set- 3 Bottles

When mothers have collected excess breast milk, we suggest to change a new storage milk bottle to collect breast milk in order to manage the amount of breast milk easily. KU.KU Duckbill Storage Milk Bottle Set- 3 Bottles are designed for mothers to storage more breast milk.

- The milk bottle can use standard nipple.
- The milk bottle can be placed on the breast pump to used as the storage milk bottle.
- Put on the nipple and cover to be used as the feeding bottle.
- Foodstuff level PP material can be sterilized by high temperature.
- It can be repeat for use which is money saving and environment friendly.



KU-5924

建議售價 NT250元



4 712702 870510