



重要！
請詳細閱讀並妥善保存作日後參考之用。

**IMPORTANT - READ CAREFULLY AND KEEP
THESE INSTRUCTIONS FOR FUTURE REFERENCE.**

委製商/進口商：吉尼寶貝國際股份有限公司

地址：彰化市茄苳路二段290巷27號

電話：04-7357958 統編：126117114

 吉尼寶貝國際股份有限公司 JINI BABY INTERNATIONAL CO.,LTD.
No.27, Lane 290, Sec.2, Jia Dong Road, Changhua City 500-84, Taiwan 台灣彰化市茄苳路二段290巷27號
電話:04-7357958 統一編號:12617114 原產地:中國 Made in China www.kukuduckbill.com.tw

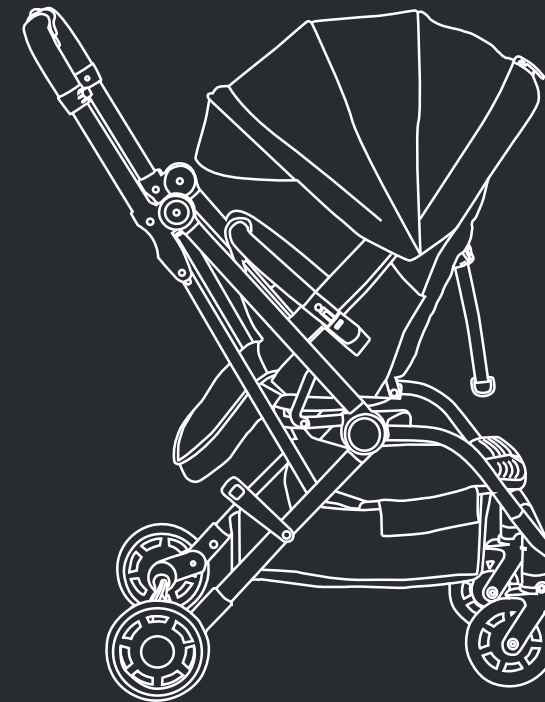

TWO-WAY ROTATING
BABY STROLLER
INSTRUCTION MANUAL

酷咕鴨
幻黑·旋轉雙向手推車
使用手冊

WARNING 警告

- 切勿留置嬰幼兒無人照顧。
- 使用前，確保所有鎖定裝置皆已正確啮合。
- 為避免傷害，確保展開與折疊本產品時與兒童保持距離。
- 不要讓兒童玩弄本產品。
- 務必隨時使用束縛系統。
- 避免因掉出或滑出而導致重傷，須隨時使用五點式安全帶將幼童固定。
- 本產品僅設計供步行使用，不適合跑步或滑冰。
- 為防止事故發生，確保手推車遠離自動閉合之門。
- 本產品最大承重為15公斤，只可載一名孩童，請勿超重。
- 本推車適合年齡0-3歲，靠背和座椅間的角度小於150°時，不適用於0-6個月的嬰兒使用。
- 請勿在推車把手上附掛任何物品，以防影響推車的穩定性。
- 僅限使用由製造商或經銷商所供應之替換零件，請勿隨便更換或使用非製造商認可之任何配件。
- 將嬰兒上下車時請將煞車固定，以免推車滑動。

保養及維護

- 為了確保您的寶寶免受意外傷害，請經常對本產品進行檢查和保養。
- 定期檢查是否有螺絲鬆動、零件損壞或縫線斷裂痕跡，如有必要請更換破損的部件。
- 布套和配件，可以使用溫和的肥皂水清潔，並保持自然晾乾，不要直射陽光。
- 局部髒汙，可用稀釋的清潔劑，以濕棉布或海綿清除汙漬，並在折疊或儲存前完全晾乾。
- 車架清理: 髒汙時及時使用軟布擦拭乾淨，並用乾布擦乾。請勿使用刺激性化學品或漂白劑進行清潔。
- 請勿長時間曝曬在陽光下或接近強熱源，避免零件老化或布料褪色。
- 長時間不使用請將推車儲存在通風良好的地方避免發霉和生鏽。
- 剎車和車輪比其他部件容易磨損，必要請與本公司維修中心連絡。

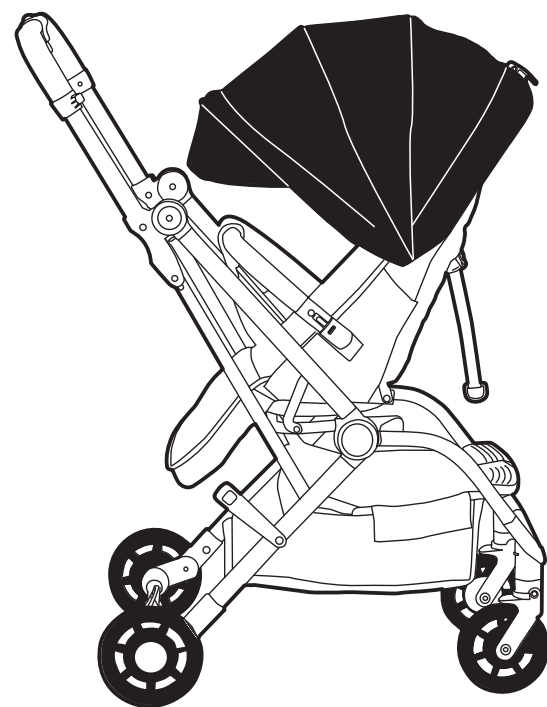

關於推車

商品名稱：酷咕鴨幻黑・旋轉雙向手推車

商品型號：KU6045

適用年齡：0~36個月之嬰幼兒

最大年齡：36個月之嬰幼兒

最大體重：15公斤以下的嬰幼兒

展開尺寸：85x53x103cm

收合尺寸：53x34x78cm

產品重量：7.6公斤

主要材質：鋁合金、塑膠、布料

⚠ 警告!本產品僅設計供步行使用

01

CONTENTS / 目錄

零件清單	03
產品示意圖	04
功能特點	05
安裝說明	06
收車步驟	07
展開步驟	08
調節說明	09
安全帶使用	11
保固與售後服務	12

02

零件分解圖

- 1 前扶手 x 1
- 2 前輪 x 2
- 3 後輪 x 2
- 4 車架 x 1

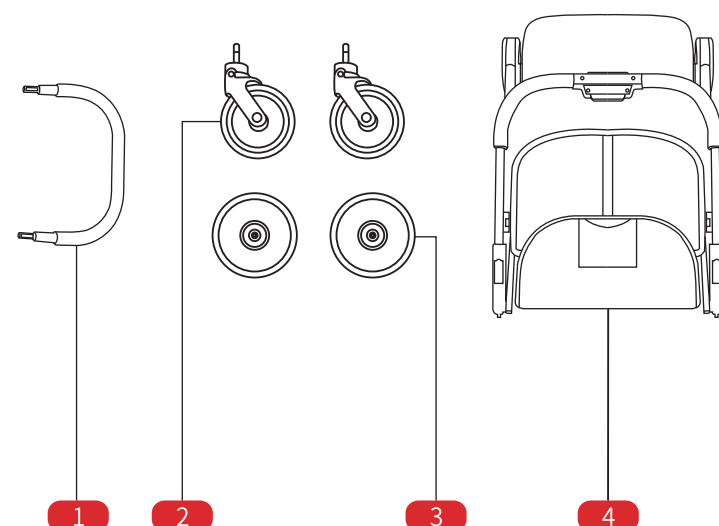

03

產品示意圖

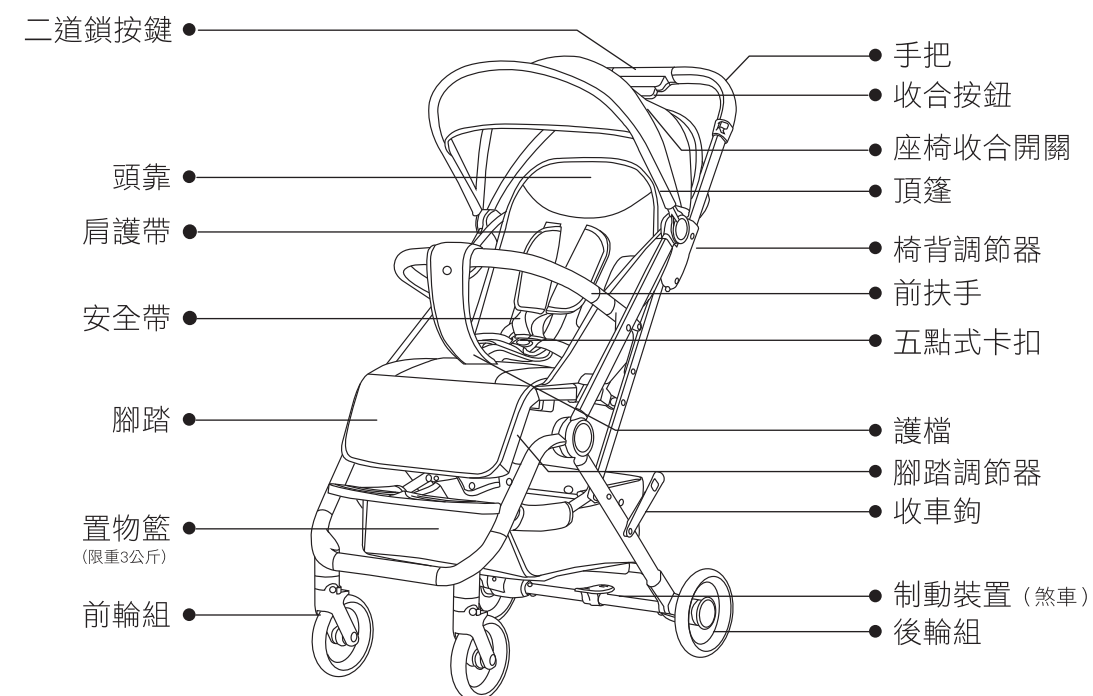

04

功能特點

1. 快捷一鍵收車

打開二道鎖往下一壓即可完成收車

2. 收車可站立

完成收車後可穩穩站立，收納更方便

3. 椅背調節

椅背可平躺，可根據寶寶需求調節任意角度

4. 五點式安全扣

自動安全扣具按下按鍵，自動彈開

5. 腳踏調節

可根據寶寶睡姿將腳踏調平方便平躺

6. 超大弧形前扶手

更寬大的前扶手設計，讓寶寶乘坐更安全舒適

7. 360° 旋轉換向

座椅360° 旋轉換向，可以隨時與寶寶正面互動

8. 一脚雙煞

在車杆外側踩下，雙後輪為煞車制動狀態

9. 四輪可拆卸

在側面按下輪子拆卸按鍵可快速拆裝四個輪子

10. 可拆卸前扶手

按下扶手側邊按鍵可打開拆卸前扶手

11. 三折收合車身

升級三折式折疊車身設計，輕便快捷

12. 單手收合

單手操作，往下一壓輕鬆操作

13. 高視覺設計

整體座椅加高，寶寶視覺景觀更好

14. 加大式頂篷

座椅覆蓋更廣，遮陽效果顯著提升

15. 創意天窗設計

增加透氣性及方便觀察寶寶動態

05

安裝說明

免工具輕鬆安裝，快速方便

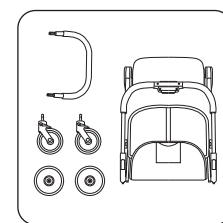

1 檢查配件

從箱子內取出所有配件以便安裝備用

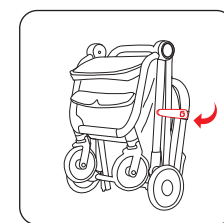

2 打開收車鉤

在車架側面打開收車鉤以便展開推車

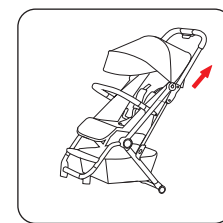

3 展開車架

拉住手把向斜上方提起車架並把車身往上抬起

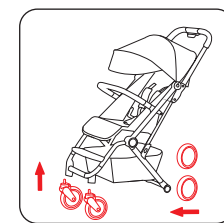

4 安裝配件

前輪安裝-向上插入前輪座，後輪安裝-側面插入後輪座，前後輪組需確實卡合到位，再安裝前扶手。



YES 安裝完成

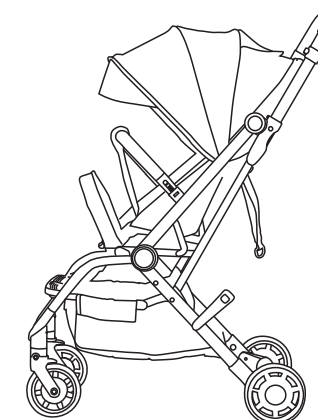

06

收合步驟



1 收車前狀態

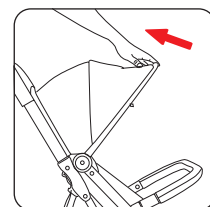

2 收起頂篷

向後拉動頂篷支架收起頂篷

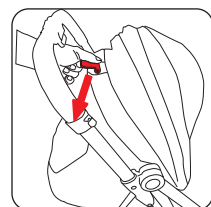

3 收合座椅支撐

單手向上提椅背收合卡扣(如圖紅色標示)，並向下壓椅背支撐管，直到椅背收合平整

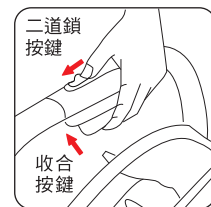

4 單手操作

單手使用拇指向下壓二道鎖按鍵，同時其他手指向內緊握手把下方的收合按鍵(如圖紅色標示)



5 收合車架

單手向下壓車架

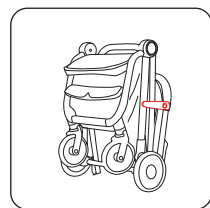

6 收合完畢

收合完畢，此時推車體積為最小狀態，卡合收車鉤

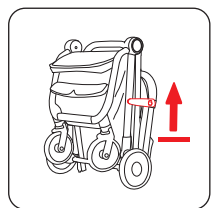

7 站立存放

收車完畢後可直接水平站立

07

展開步驟

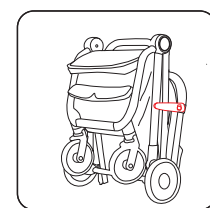

1 展開前狀態

展開前，此時推車體積為最小狀態

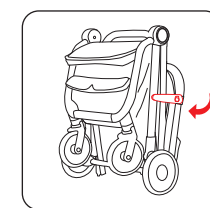

2 打開收車鉤

在車架側面打開收車鉤以便展開推車

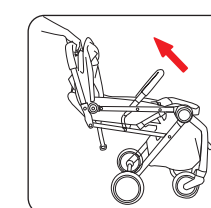

3 展開車架-1

拉住手把向斜上方提起車架



4 展開車架-2

當聽見“喀”聲響後車架展開完畢

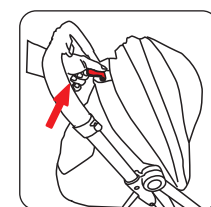

5 打開座椅支撐

單手向上打開椅背收合卡扣(如圖紅色標示)，並向上提起椅背支撐管，直到聽到“喀”聲，座椅打開並固定

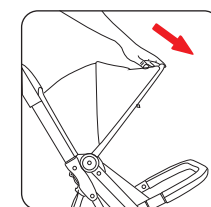

6 展開頂篷

將頂篷支架向前拉開直至到位

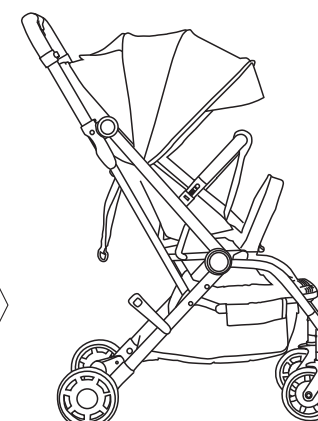

7 展開完畢

08

調節說明

1.如圖
椅背調節
將椅背調節器扣具的左右按鍵同時抓住向下拉，椅背展開

3.如圖
腳踏調節
腳踏可抬起，方便平躺
可根據寶寶睡姿使用兩側
按鈕調節使用

5.如圖
360° 旋轉座椅
旋轉座椅

2.如圖
椅背調節
將椅背調節器扣具的左右按鍵同時抓住向上收緊，椅背抬起

4.如圖
座椅旋轉
將腳踏如圖抬起，同時往任何一個方向旋轉座椅(注意旋轉的時候需把椅背打直)

6.如圖
固定座椅
等座椅旋轉到反面(正面)中間時，放下腳踏，聽到“喀”聲鎖定座椅。

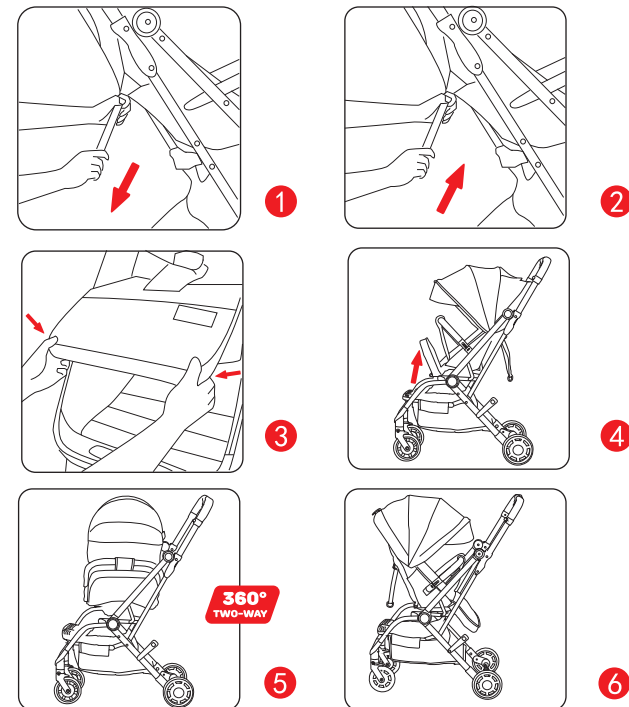

09

調節說明

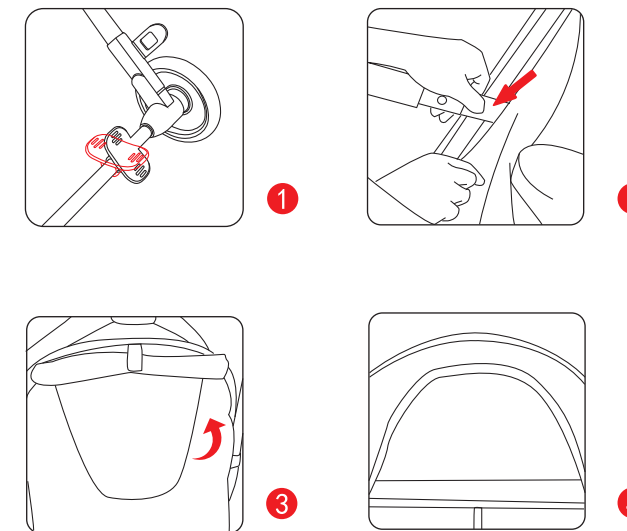

1. 如圖
煞車調節
踩下煞車器內側或外側
即可煞車或解開

2. 如圖
拆卸前扶手
同時按下扶手側邊卡榫
即可取出扶手

3. 如圖
後窗通風設計
打開後部側布即可
打開後天窗

4. 如圖
天窗設計
網狀天窗設計，
方便媽媽時刻觀察寶寶

10

安全帶使用

警告:
為避免嬰兒從推車內滑出
請務必隨時使用安全帶！

- 1.使推車固定不動;
- 2.扣上腰部安全扣，將兩邊安全扣插入母扣中，聽見“喀”一聲表示卡合(圖1-2)；
- 3.可按(圖3)所示的安全帶“日”字扣，進行調節五點式安全帶的長度，使之更適合您的寶寶。
- 4.需解開安全帶時，按下安全扣中間按鈕，可自動彈開安全扣(圖4)。
- 5.孩子長大後，從固定扣取出可以延長肩帶(圖5-6)。

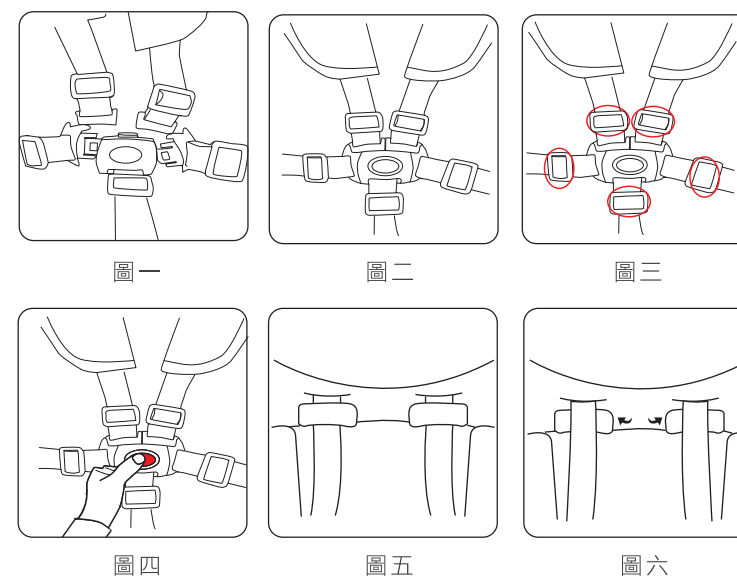

11

保固與售後服務

- 1.本公司銷售之手推車出廠前經嚴格品管，在正確使用及保養下應能正確地表現其優越性能
- 2.本產品自購買日期開始，享有一年內免費維修之售後服務(運費恕不在此列內)
- 3.本保證卡如有遺失，恕不補發，敬請妥善保存
- 4.本保證卡所提供之售後服務，不適用下列情況：
(1)使用不當或不慎摔落、泡水、潮濕所造成之故障及損壞
(2)自行拆裝所發生之破損或故障等，恕不列入保證範圍
- 5.為保證顧客之權益，請務必填寫購買日期並加蓋經銷商之店章，否則本公司將以本產品之製造日作為保證期之起算日；線上購買將以下單當日為起算日
- 6.未經本公司經銷商蓋章，或塗改購買日期者，一律視為無效

酷咕鴨幻黑・旋轉雙向手推車【售後服務保證卡】		
購買日期：	貨號：KU6045 酷咕鴨幻黑・旋轉雙向手推車	
姓名：	電話：	店章：
地址：	店家：	

12

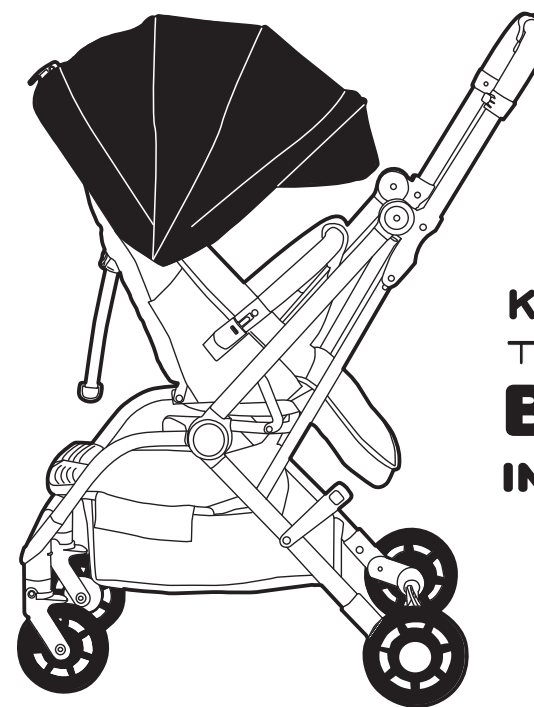

KU-KU Duckbill
TWO-WAY ROTATING
BABY STROLLER
INSTRUCTION MANUAL

WARNING

- Never leave the child unattended.
- Ensure that all the locking devices are engaged before use.
- To avoid injury ensure that the child is kept away when unfolding and folding this product.
- Do not let the child play with this product.
- Always use the restraint system.
- Avoid serious injury from falling or sliding out. Always use seat belt.
- This product is designed for walking use only, not suitable for running or skating.
- To prevent accidents, keep the stroller away from the door that closes automatically.
- The maximum load for the baby stroller is 15kg and overload forbidden. This baby stroller is designed for one child.
- The baby stroller is suitable for baby 0-3 years and is not suitable for infants aged 0-6 months when the angle between the backrest and seat is less than 150°.
- Any load attached to the handle affects the stability of the stroller.
- Only replacement parts supplied by the manufacturer/distributor shall be used. Any accessories which are not approved shall not be used.
- Make sure the baby stroller is braked when placing and removing the children.

CARE AND MAINTENANCE

- It is necessary to check and maintenance often to avoid your baby from any injury by accident.
- Check regularly if there are loosen screws, damaged parts or crack in cloth replace them as necessary.
- Wipe the fabric with mild soap and cold water and let it air dry.
- For especially dirty parts, please diluted detergent and clean it with damp cotton cloth or sponge.
- Wipe the metal and plastic parts of the stroller with a wet cloth then wipe it dry after that. Do not use harsh chemicals or bleach for cleaning.
- Do not let your stroller in direct sunlight or near strong heat sources for a long time. Otherwise, the plastic and fabric parts will fade.
- Leave the stroller in well-ventilated room to prevent the fabric from getting moldy and the frame from rusting.
- The brakes and wheels wear out faster than other parts. Replace them when necessary.

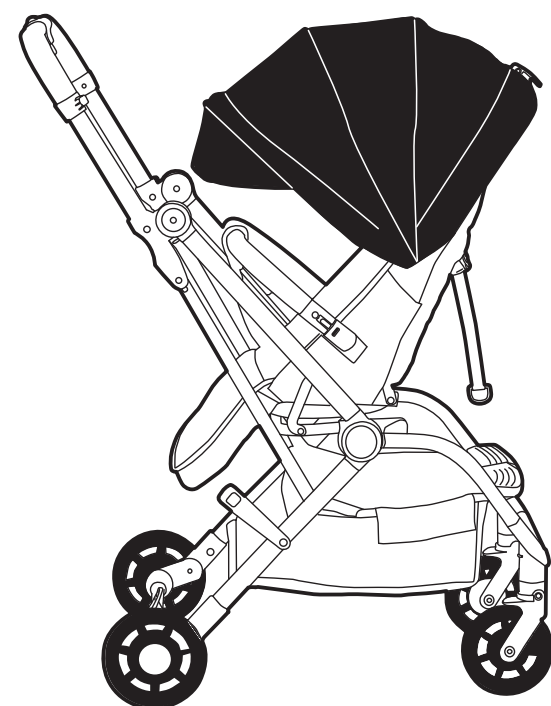

About Stroller

KU.KU Duckbill Two-Way Rotating Baby Stroller

Item No.: KU6045

Applicable age: 0 to 36 months

Maximum weight: below 15 kg

Unfold Size : 85x53x103 cm

Folded Size : 53x34x78 cm

Weight : 7.6kgs

Material: aluminum tube, polyester

WARNING!
THIS PRODUCT IS DESIGNED FOR
WALKING USE ONLY.

01

CONTENTS

Part List	03
Product Overview	04
Features	05
Assembly Stroller	06
Fold Stroller	07
Open Stroller	08
Adjustment	09
Use Safety Belt	11

02

Part List

- 1 Front Armrest x 1
- 2 Front Wheels x 2
- 3 Rear Wheels x 2
- 4 Frame x 1

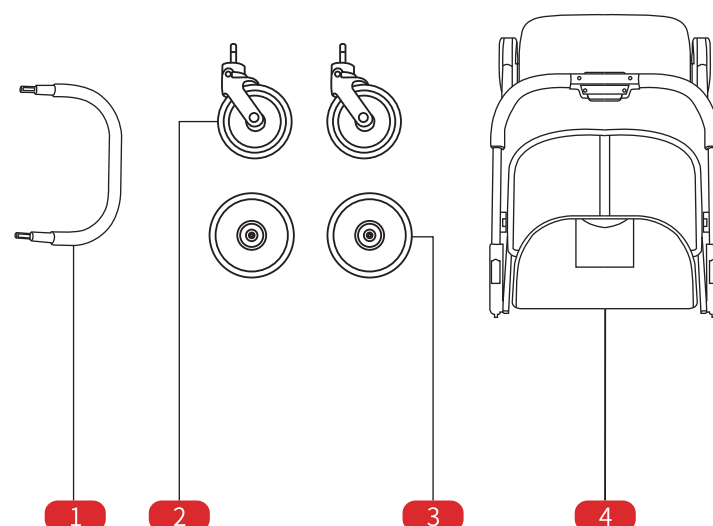

03

PRODUCT OVERVIEW

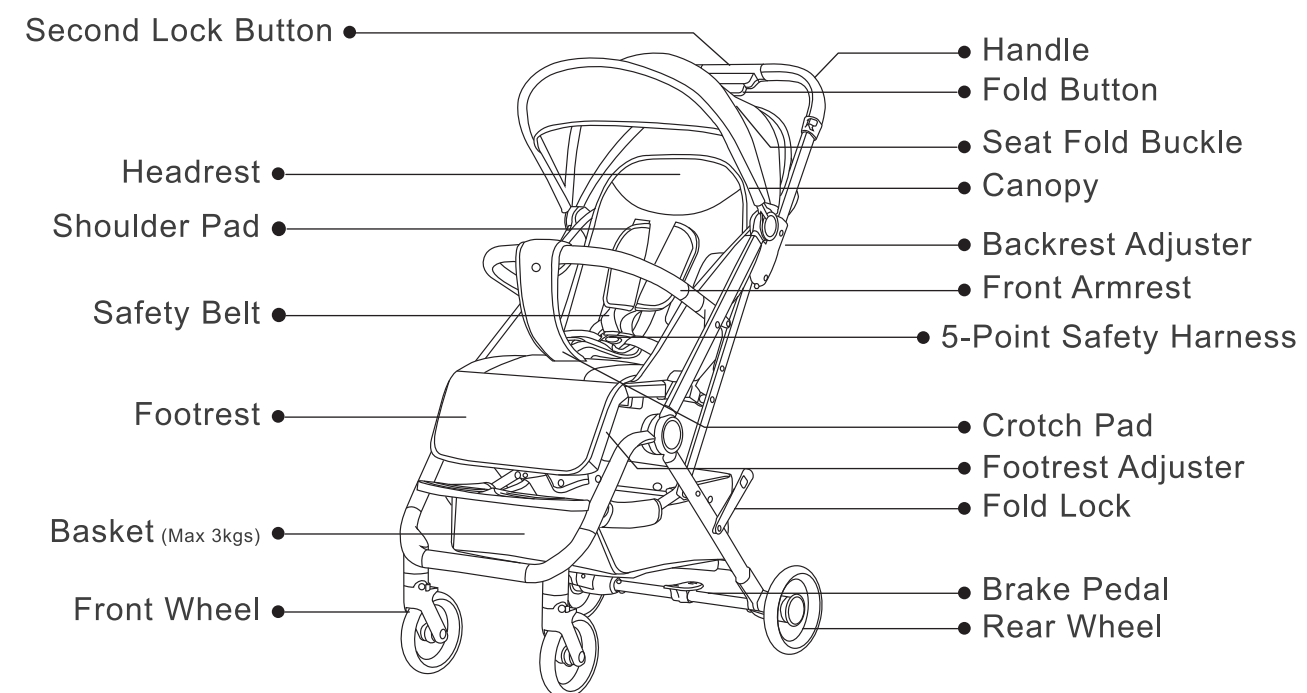

04

FUNCTION CHARACTERISTIC

1.Fast Folding

open the second lock and push to fold the stroller.

2.Self-Standing Fold

The folded stroller can stand by itself for easy storage.

3.Reclining Seat

A reclining seat allows you to position your child for comfort.

4.5-Point Safety Harness

With easy harness adjustment and push-button release.

5.Adjustable Footrest

The foot pedals can be adjusted to flat when baby is sleeping.

6.Comfort Front Armrest

The wider front armrest design makes it is safer and more comfortable for your baby.

7. 360° Rotation Seat

Baby can ride 2 ways –facing front or back allows them to interact with you or observe their surroundings.

8.One-Foot-Use Brakes

With the brakes that lock both the rear and front wheels will provide the most stability and safety.

9.Removable Wheels

Four wheels can be quickly disassembled by pressing the button on the side of wheels.

10.Removable Front Armrest

The Front Armrest can be opened by pressing the button on the side of Armrest.

11.Three-Fold Folding Frame

Upgraded three-fold folding stroller frame for easy and fast use.

12.One-Handed Fold

One-handed fold stroller that allows you to collapse the stroller with the push of a button.

13.High Visual Design

The raised seat offering your child a good viewing.

14.XXL Canopy

The Extended canopy for better sun protection.

15.Top Window

Mesh screen on the top ensures good ventilation and watch your baby.

05

ASSEMBLY PROCESS

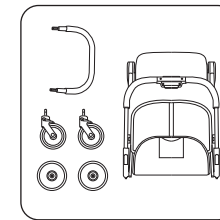

- 1 Check the part**
Take out all accessories and the stroller frame.

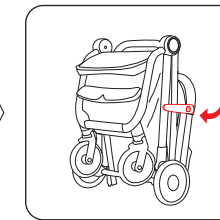

- 2 Unlock the folding hook**
Release the hook on the side of stroller.

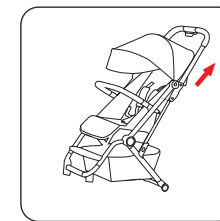

- 3 Unfold the stroller**
Lift the stroller frame as the arrow direction till a click is heard to make sure the stroller fully open.

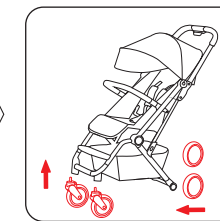

- 4 Attach the wheel and armrest**
Install front wheel assembly into front wheel shaft until it is installed in position.
Install rear wheel assembly into rear wheel shaft until it is installed in position.
Install front armrest into the hole until it is installed in position.

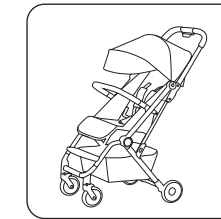

YES INSTALLATION COMPLETE

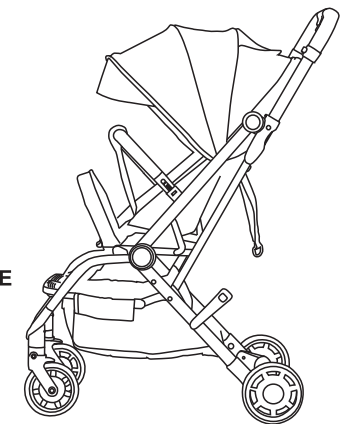

Tool free assembly-Quick and easy

06

FOLDING PROCESS



- 1 The stroller before folding**

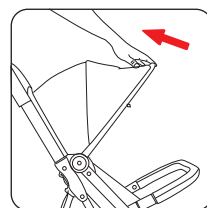

- 2 Fold the Canopy**
Simply push backwards to close canopy.

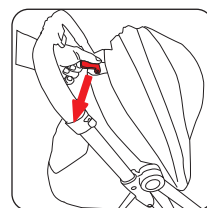

- 3 Seat Retraction**
Pull the Seat Folding Buckle and fold down the Backrest until it is folded flat.

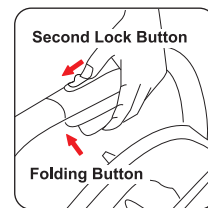

- 4 One hand handle**
Slide the Second Lock Button as red arrow direction, then press the Folding Button as red arrow direction.



- 5 Stroller Retraction**
Push down the stroller frame till a click is heard to make sure that the stroller is folded completely.

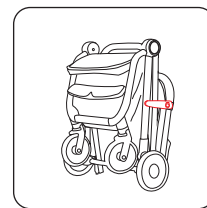

- 6 Fold Complete**
Make sure the Fold Lock is locked.

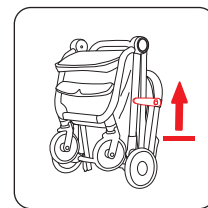

- 7 Standing storage**
The folded stroller can stand by itself.

07

UNFOLDING THE STROLLER

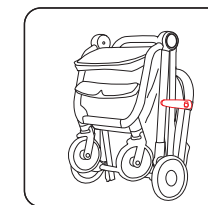

- 1 Take out the stroller**
Take out the baby stroller from carton

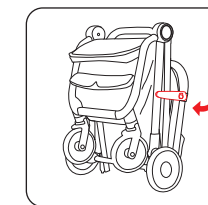

- 2 Open the stroller**
Open the Fold Lock in the direction of the arrow

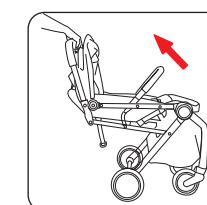

- 3 Unfold Stroller-1**
Lift the stroller frame as red arrow direction



- 4 Unfold Stroller-2**
Till a click is heard to make sure the stroller fully open.

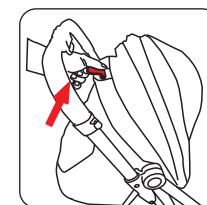

- 5 Seat Retraction**
Open the backrest support buckle, upwards until you hear a click, and make sure that the backrest is fully extended.

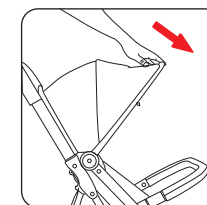

- 6 Open the canopy**
Pull the front edge of the canopy to open

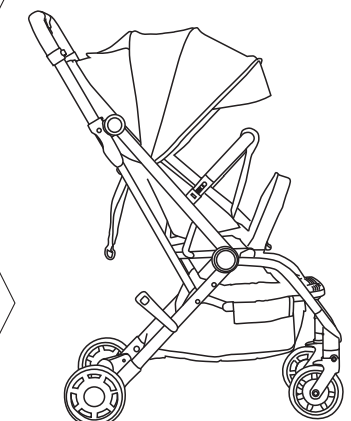

- 7 Unfold Complete**

08

ADJUSTMENT

1.Backrest Adjustment (Figure 1)

To Recline the Backrest, squeeze both buttons on Recline Adjuster and pull down until you reach the desired position.

2.Backrest Adjustment (Figure 2)

To adjust the Backrest into an upright position, squeeze both buttons on Recline Adjuster and pull on.

3.Footrest adjustment (Figure 3)

There is a button under the footrest, press buttons on both side can raise or lower the footrest which is easy for baby sleep.

4.Seat Rotation (Figure 4)

Lift the footrest as shown in the figure 4, and rotate the seat in any direction (note that you need to straighten the backrest when rotating)

5.360° Rotation (Figure 5)

Rotating the seat.

6.Lock The Seat (Figure 6)

Until the seat rotates to the center of the back (or front), lower the footrest, and hear "Click".

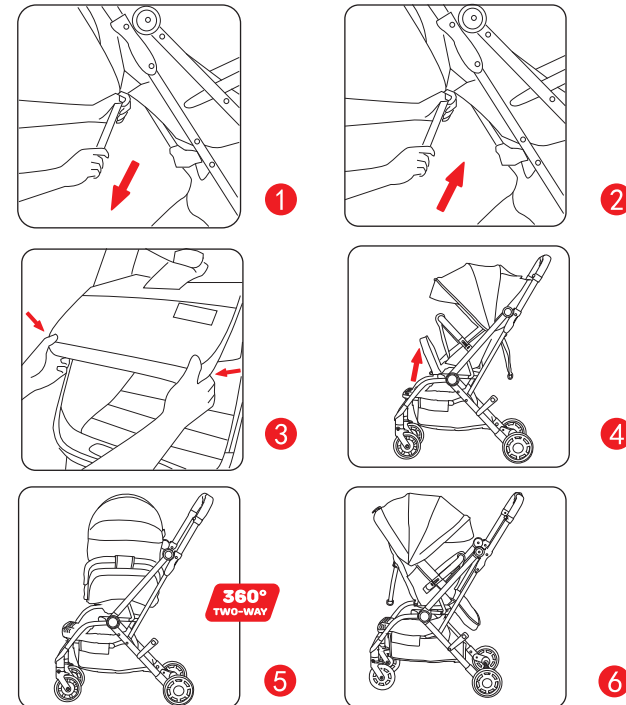

09

ADJUSTMENT

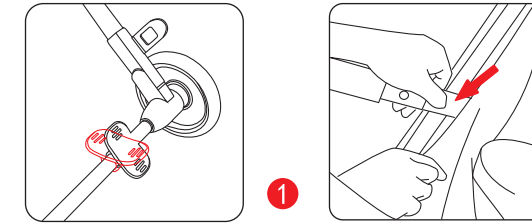

1.Brake (Figure 1)

Tread the brake pedal downwards to lock the stroller. Lift the brake pedal upwards to unlock the stroller.

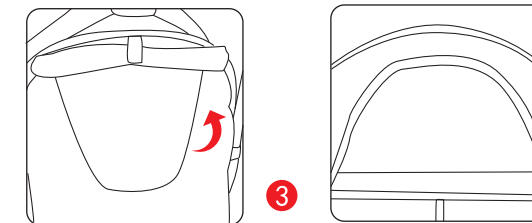

3.Back Window (Figure 3)

To open the Back window, lift up on the flap on the back of the Canopy.

2.Disassemble the front armrest (Figure 2)

Press the armrest disassemble button and pull the armrest at the same time.

4.Top Window (Figure 4)

To open the Top window, lift up on the flap on the top of the Canopy

10

SAFETY BELT USING

⚠ WARNING

Avoid serious injury from falling or sliding out.
Always use safety harness system

1. Lock the stroller with brake
2. Buckle: insert safety buckle plug into the receptacle together till a click is heard to be buckled up. (Figure 1.2)
3. The harness strap can be adjusted by moving each strap's slider. Adjust the length of the seat belt as diagram shown, and child should always wear the seat belt while seated. (Figure 3)
4. Unbuckle: pressing the center button. (Figure 4)
5. When the child grows up, the shoulder strap can be extended by passing through the fixed buckle. (Figure 5.6)

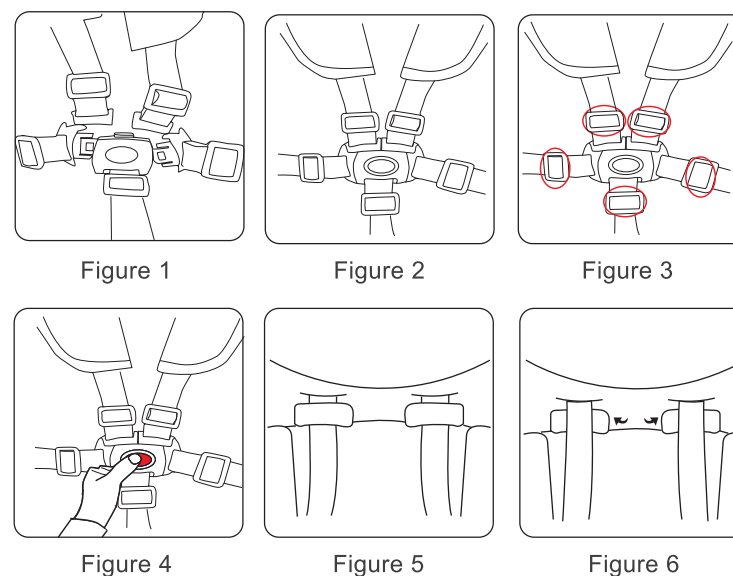

11